

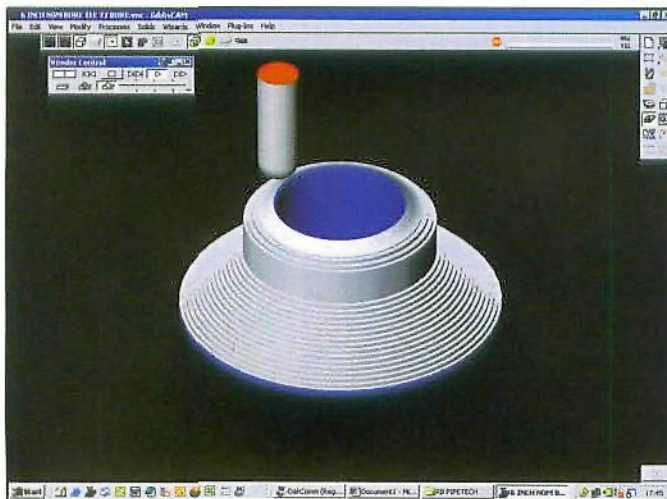

Rapid Product Development

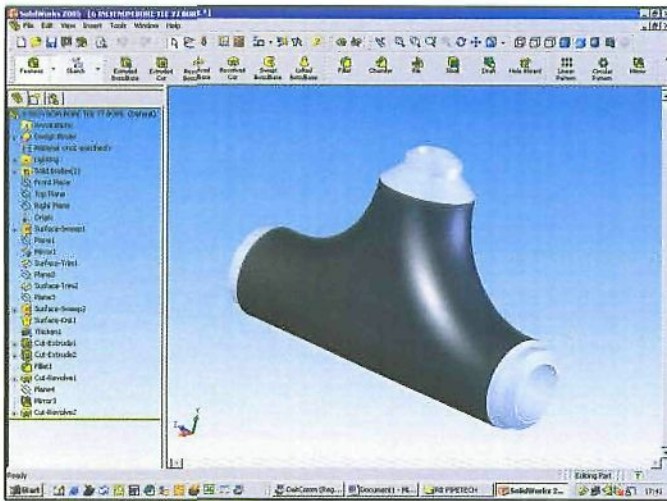

Recent investments have been made in three key product led areas:

- CNC machinery with fourth axis capability
- Advanced solid modelling design software
- CAD/CAM software for rapid CNC program development

This results in rapid product development from customer enquiry to production and delivery.

As part of this process we can gain further customer input remotely by sending them an electronic drawing which can be manipulated to view the item from all angles or see each individual part in an assembly.

This process has led to successful development of bespoke products .



The pictures on this sheet show the various steps in the product cycle of a tee used in the offshore oil industry:

Top - the tee is modelled to obtain the geometry.

Above - the geometry is transferred into the CAM package to produce a program for the CNC machines. Proof running ensures that the desired profile can be achieved

Right - final machining.



Examples of Rapid Product Development with Customer Input

Right - Single gob 6-1/4" SG funnel arm. Designed with quick change bracket, the arm is straight rather than cranked so that it can be used upside down.

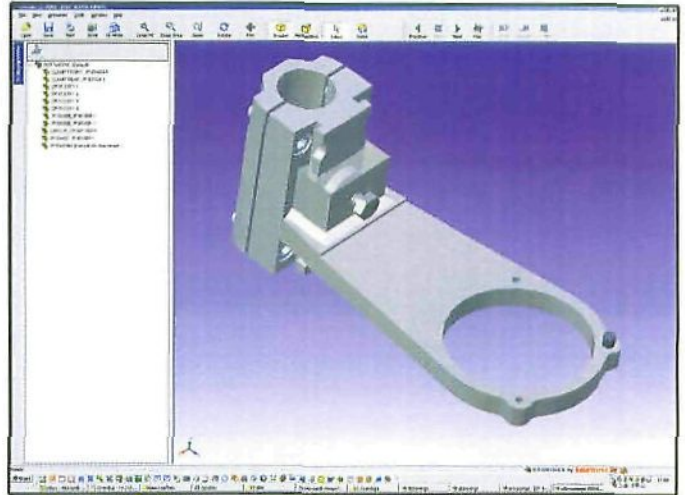

Below and Below Right - Newly developed 5-1/2" blank wind cooling damper housing machined from a solid blank

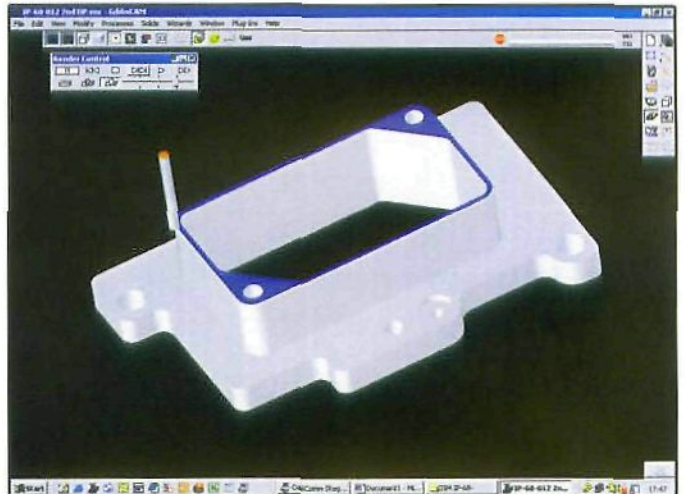

Right - Development of a laser alignment fixture

